

Battens with Emergency Lighting



Sirius is a cleverly crafted batten that cast light evenly to brighten its surroundings including the ceiling for better ambience in undercover carparks. It is highly diffused to minimise glare to prevent anxiety especially for the elderly with poor visual acuity.

There is less messing around with Sirius 1200mm and 600mm battens. Cables can be inserted from the top, its short ends, or its long ends and the entry points need not be waterproofed but must be dustproofed. Only the cable connectors between Sirius and the mains must be electrically safe. Moist air is allowed to enter/exit its dust proof enclosure to prevent condensation, and any external water that enters its enclosure would drain away or evaporated in the slightly hotter enclosure. Sirius sensible approach have all high voltage devices, such as its driver, encased in heat-conductive epoxy and its low voltage electronic components, such as its LEDs, weatherproofed.

Sirius has a low plastic content; its body is made from high thermal conductive aluminium for a cooler operation. Besides being more ecofriendly, the aluminium body enhance its efficacy and lumen depreciation below 4% when continuously lit within its 7-year warranty period. It goes without saying, that Sirius inherent quality demands a non-toxic Lithium Iron Phosphate for emergency lighting.

In most cases a 20W Sirius is a realistic replacement for twin-4ft fluorescent battens. For quality LEDs like Sirius with a depreciation of less than 1% per annum, the U.S. Department of Energy (DOE) suggest using the intended lighting lifespan to set the initial lighting level for better energy savings instead of simply stipulating L70 or L80. Sirius power can be increase up to 30W should more lumens be needed.

Sirius 1 for 1 twin T8/T5 replacement at 20W

LoRa wireless & emergency light options

Standard Specification

Input power range:	20W*
Efficacy	123 lm/W @ 20W
Driver (DALI-2):	BK-PUL018A-0450Ad
Beam angle:	120°(H), 110°(V)
CRI (standard):	83 (Ra) 5.9 (R9)
CRI (optional):	95 (Ra) 78 (R9)
Colour temperature:	Cool white, 5000K Neutral white, 4000K Warm white, 3000K
UGR:	<14-23
SCDM:	3
LLD(Av):	2.21% @ 12,000 hrs
Diffuser:	Polycarbonate
Chromaticity shift (Av):	0.0012 @ 12,000 hrs
Fitting Material:	Zinc coated steel
Fitting colour:	Metallic
IP rating:	IP65
Input Voltage:	180-264Vac
Power factor:	>0.97@20W
Operating temperature:	-20°C to 45°C
Approved standards:	SAA, C-Tick
Life expectancy (L70):	>150,000 hrs (Calc) >60,000 hrs (Reported)

Luminaire warranty (L80):	5 yrs including driver
Weight:	2.5Kg
Lighting control system:	DALI-2 wired LoRa i3t
LoRa i3t Lighting control:	64,000 Lamp and device Nodes
Easy setup:	Simple point-n-click zoning with multi-level grouping option
	0-100% zone or group dimming
	Ambient light correction
	Room correction factor
	Occupancy sensing

Options

OEM integration:	BacNet, KNX, Modbus S-Mode, Desigo Zen Control
30W option:	37,000 lumen
Custom colour:	Yes
Custom Dimensions:	Yes

* Half size troffer input power: 12W
Other wattages available

Ordering Information

Note: New part number, all else unchanged

BAT**S**a**b**-**cd**-**ef**-**g**

a:	watts e.g. BAT 20 . . . = 20W
b:	DALI-2 driver S tandard driver
c:	Cool white, N eutral white, W arm white,

d:	1 (600mm), 2 (1200mm), 3 (1800mm), 0 : Custom size
e:	L ora i3t, B lank (no LoRa)
f:	P IR, M icrowave, C ombined PIR & Ambient sensor B lank (no sensor)
g:	E mergency



SIRIUS Photometric Chart

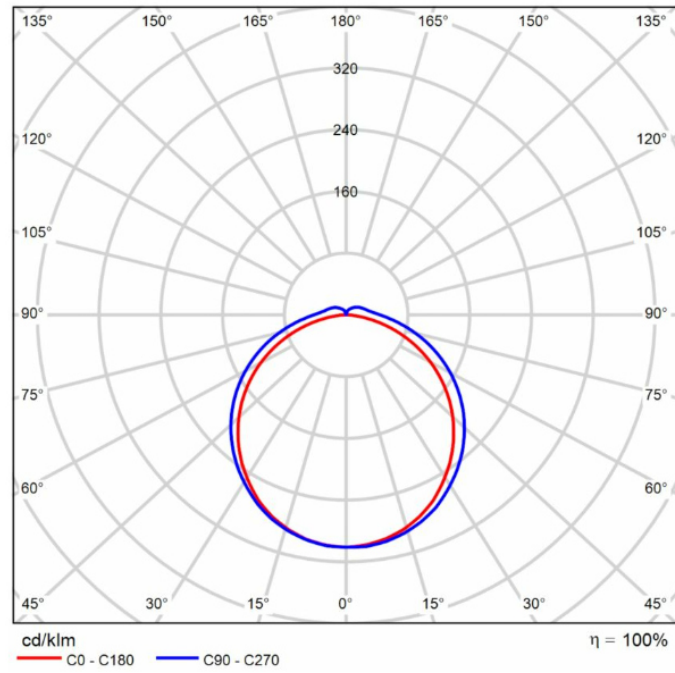

Dimensions

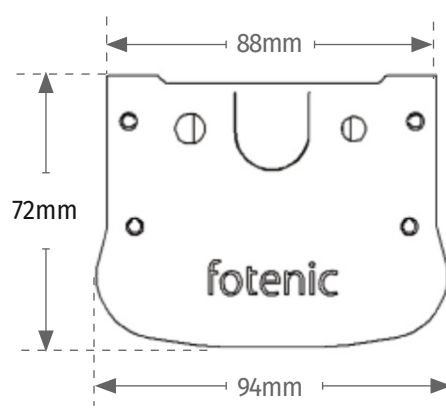
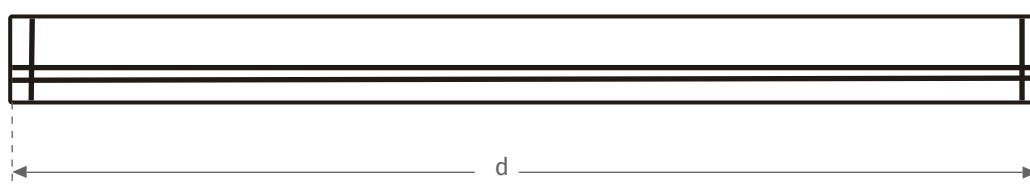

SideView

*Custom dimensions available for bulk orders

Batten with Emergency Lighting option

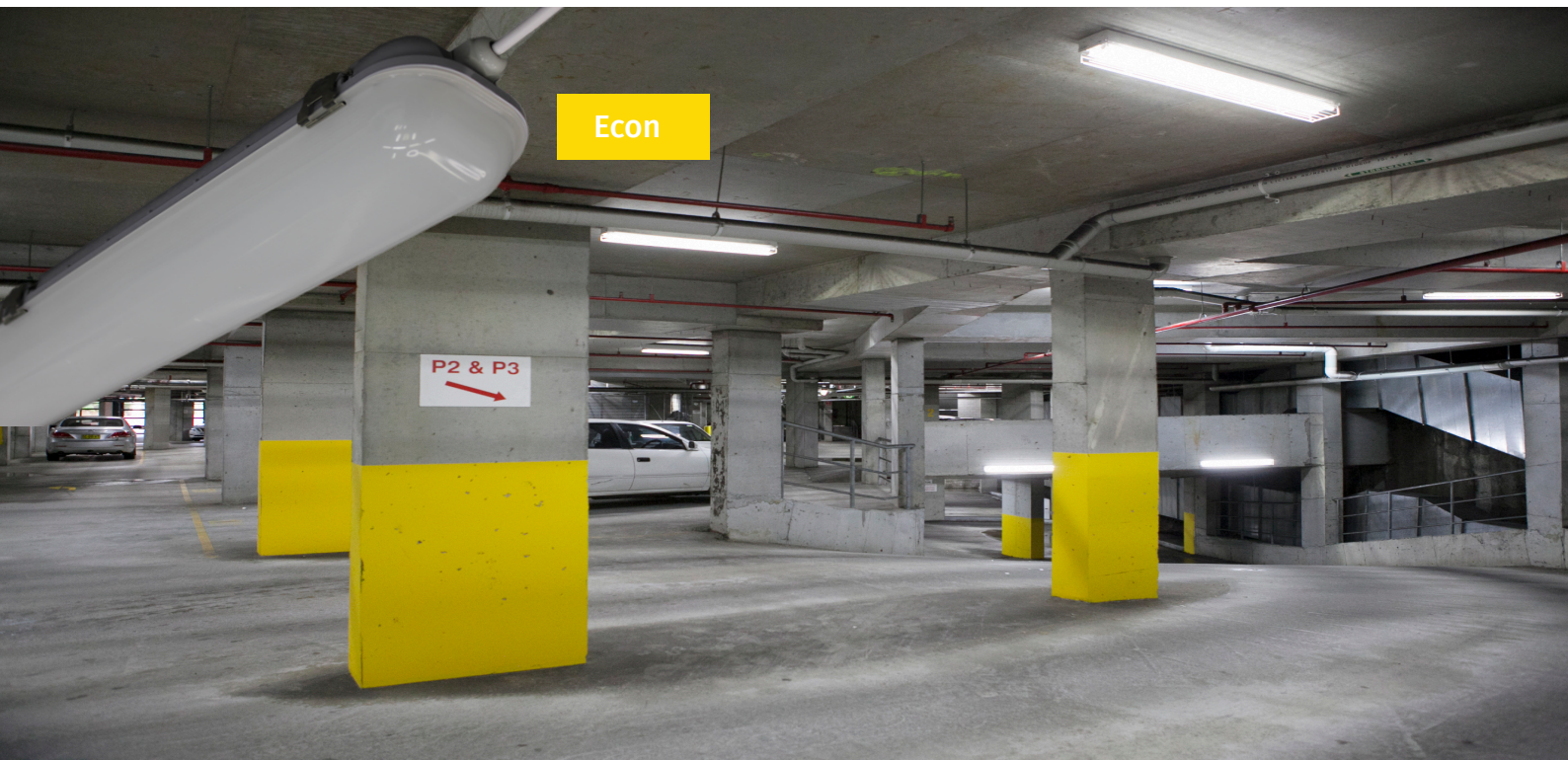

Econ uses the traditional approach of waterproofing battens. It is airtight to prevent moisture from entering the fixture. It is made from tough “indestructible” polycarbonate. Care must be taken to make sure its seals are not damaged during installation and all entry points are sealed.

Its polycarbonate diffuser has a beam

angle approximately 100o and throws light evenly on the floor in most undercover configuration and can be a good replacement for existing T8/T5 twin fluorescence tube battens.

Econ has a 5 year warranty and has an emergency light option that uses non-toxic Lithium Ferrous Phosphate batteries with approximately 5,000 recharging cycle.

Econ 1 for 1 twin T8/T5 replacement at 23W

LoRa wireless & emergency light options

Standard Specification

Input power range:	23W*
Efficacy	123 lm/W @ 20W
Driver (DALI-2):	BK-PUL018A-0450Ad
Beam angle:	120°(H), 110°(V)
CRI (standard):	83 (Ra) 5.9 (R9)
Colour temperature:	Cool white, 5000K Neutral white, 4000K Warm white, 3000K
UGR:	<14-23
SCDM:	3
LLD(Av):	2.21% @ 12,000 hrs
Diffuser:	Polycarbonate
Chromaticity shift (Av):	0.0012 @ 12,000 hrs
Fitting Material:	polycarbonate
Fitting colour:	grey
IP rating:	IP65
Input Voltage:	180-264Vac
Power factor:	>0.97@20W
Operating temperature:	-20°C to 45°C
Approved standards:	SAA, C-Tick
Life expectancy (L70):	>100,000 hrs (Calc) >60,000 hrs (Reported)

Luminaire warranty (L80): 5 yrs including driver

Weight: 2.5Kg

Lighting control system: DALI-2 wired
LoRa i3t

LoRa i3t Lighting control:

64,000 Lamp and device Nodes
Easy setup:
Simple point-n-click zoning
with multi-level grouping option
0-100% zone or group dimming
Ambient light correction
Room correction factor
Occupancy sensing

Options

OEM integration: BacNet, KNX, Modbus
S-Mode, Desigo
Zen Control

* Half size troffer input power: 12W

Ordering Information

Note: New part number, all else unchanged

BATEab-cd-ef-g

a: watts e.g. BAT**20**. . . = 20W

b: DALI-2 driver **S**tandard driver

c: Cool white, **N**eutral white, **W**arm white,

d: **1** (600mm), **2** (1200mm),
3 (1800mm), **0**: Custom size

e: Lora i3t, **B**lank (no LoRa)

f: **P**IR,
Microwave,
Combined PIR & Ambient sensor
Blank (no sensor)

g: **E**mergency

